



FLUSH WALL DOOR SYSTEM 2024

FLUSH WALL DOORS

Suppose interior doors made of wood are integrated into their surroundings (wall, room) aesthetically. In that case, a flush door with skirting boards flush with the wall is the perfect solution.



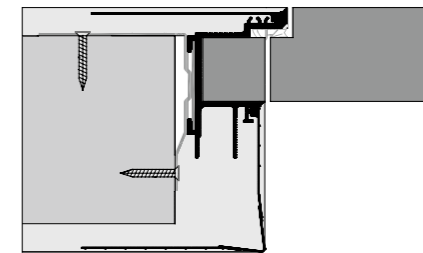

Invisible TUS50 frame, In-swing,
Door thickness: 50mm

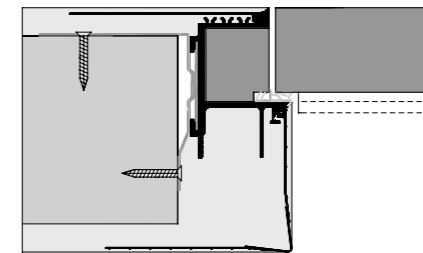

Invisible TUT45 frame, Out-swing,
Door thickness: 45mm

Flush wall door with concealed frame and flush wall skirting. Primer door or factory pre-finished door

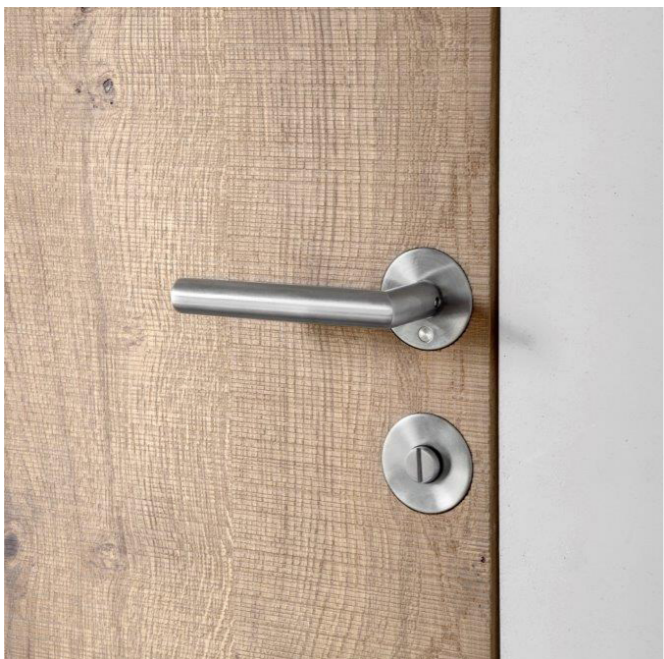

Flush Wall Door, concealed frame, door panel
in gray oak finish



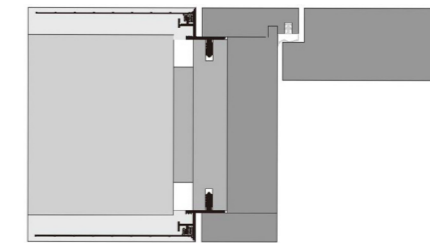

TL profile with wooden frame

Flush wall door paint grade with shadow gap profile system combined with flush wall skirting

Flush wall door, natural oak, with shadow gap profile system Combine with flush wall skirting



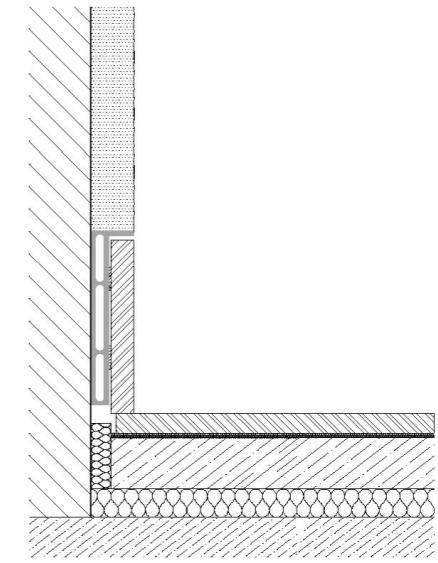

Flush wall skirting system



STANDARD VENEER STAINED COLOURS



Ice oak



Light ice oak



Clay gray oak



Light clay gray oak



Natural oak



Walnut oak

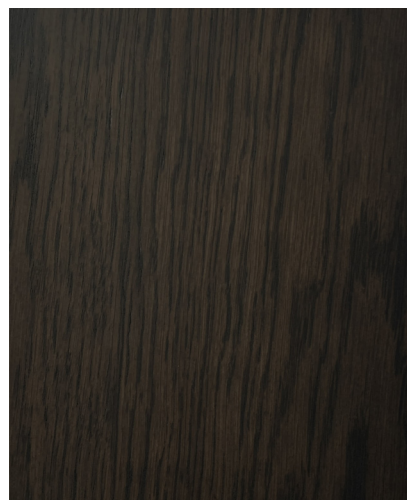

Black oak

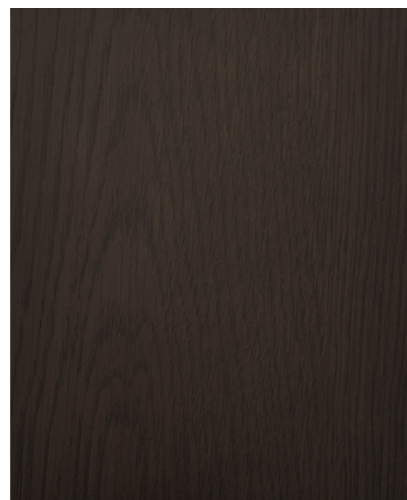

Wenge oak



Dark wenge oak

STANDARD MATT AND GLOSSY PAINT



RAL 1014



RAL 9018



RAL 7035



RAL 7036



RAL 9001



RAL 1019

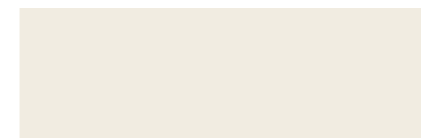

RAL 9010



RAL 1013

STANDARD OPEN GRAIN LAQUERED COLOURS



Ivory lacquered oak
RAL1014

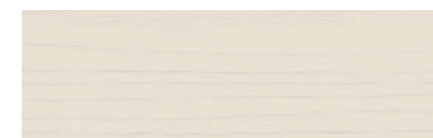

Cream lacquered oak
RAL9001

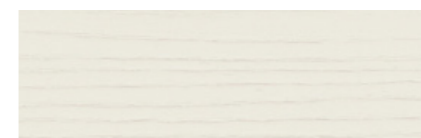

White lacquered oak
RAL9010



Pebble gray lacquered oak
RAL7032



Light gray lacquered oak
RAL7035

TECHNICAL DRAWINGS

- Door panel in aluminum honeycomb core, 50mm door thickness
- Door finishing: primer or pre-finished as request, or stain veneered.
- Unique aluminum frame with solid wood inserted for easy machining
- Snap-in mesh to avoid cracking between frame and wall.
- 3D adjustable concealed hinges, magnetic lock set.

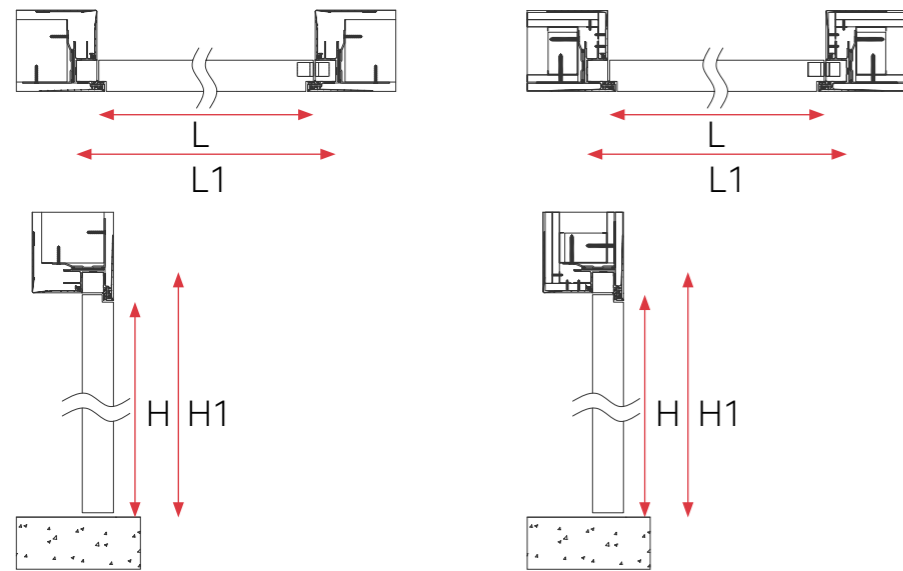

Push Opening

L - finished opening width
600-900mm. 24"-36"

H - finished opening height
Max 3000mm, 118 - 1/4"

L1 - rough opening width

L + 120mm

H1 - rough opening height

H + 60mm

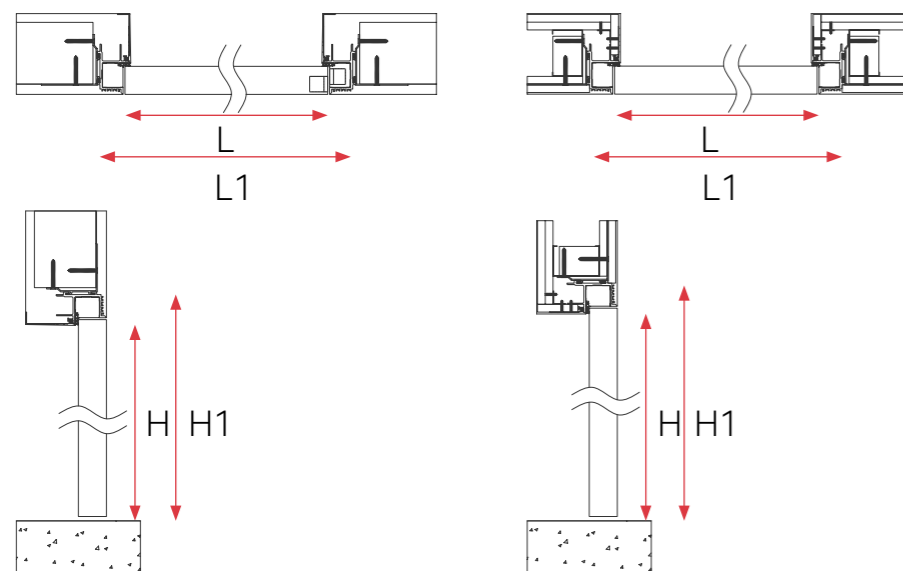

Pull Opening

L - finished opening width
600-900mm. 24"-36"

H - finished opening height
Max 3000mm, 118 - 1/4"

L1 - rough opening width

L + 120mm

H1 - rough opening height

H + 60mm

Masonry Wall

Dry Wall

