

ARCHITECTURAL WOOD DOOR CATALOGUE

2024

CONTENTS

FLUSH WOOD DOOR	01-16
PAINT GRADE FLUSH DOOR	03-04
STAIN GRADE VENEER FLUSH DOOR	05-06
HPDL FLUSH DOOR	07-08
CONSTRUCTION	09-10
FLUSH DOOR CORE OPTIONS	11-12
CUSTOM DOOR OPTIONS	13-14
FLUSH DOOR DESIGN OPTIONS	15-16
STILE & RAIL WOOD DOOR	17-34
PAINT GRADE STILE & RAIL DOOR	19-20
STAIN GRADE VENEER STILE & RAIL DOOR	21-38
CUSTOMIZED DESIGN OPTIONS & PROFILE DESIGN OPTIONS	23-24
DOOR DESIGN OPTIONS	25-26
STAIN COLOR OPTIONS	27-28
ADDITIONAL PRODUCT INFORMATION	29-30
TYPICAL WOOD FRAME DESIGN	31-32
COOPERATED HARDWARE SUPPLIER	33-34

FLUSH WOOD DOOR

Nowadays, a 'modern' functional look is becoming fashionable, purpose-made flush doors are widely accepted and available. Because of the affordability, versatile and contemporary appearance, we take it as the important one of our product series.

Various veneer options and decoration choices such as V-groove carving and metal strip inlay give flush door more design availability to match all architectural design concepts.

Paint Grade Flush Door

Stain Grade Veneer Flush Door

HPDL Flush Door



PAINT GRADE FLUSH DOOR

TDM Luxury Doors paint-grade flush doors are upgraded to a commercial quality standard with affordability and versatility.

Take high-density fiberboard as the substrate to ensure the best paint surface effect and provide various familiar design options with deep relief or simple, pleasant lines. Paints are professionally factory applied to ensure the highest quality color, sheen, tint, and tone.

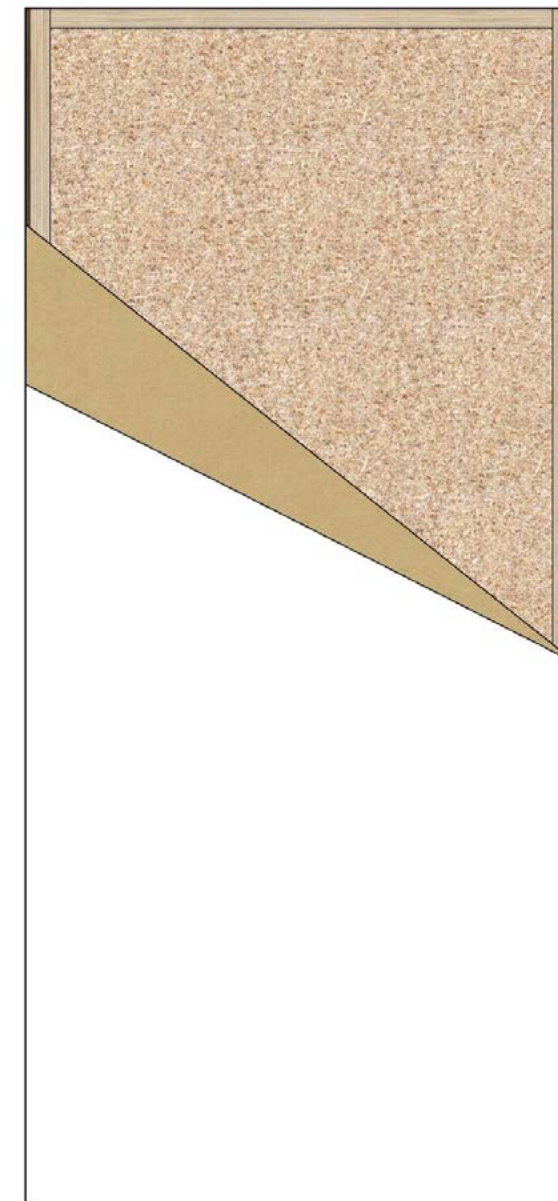

- 3-ply construction, bonded core
- Custom carving design or metal strips inlay available for modern stylish appearance
- Particleboard core, agrifiber core, are sound core and mineral core options available
- Primer or catalyzed polyurethane finish to meet WDMA OP-6
- Factory-machined to meet exact requirements for door hardware
- Meets UL 10C positive-pressure fire ratings: 20-, 45-, 60- and 90-minute
- Sound core up to STC 42

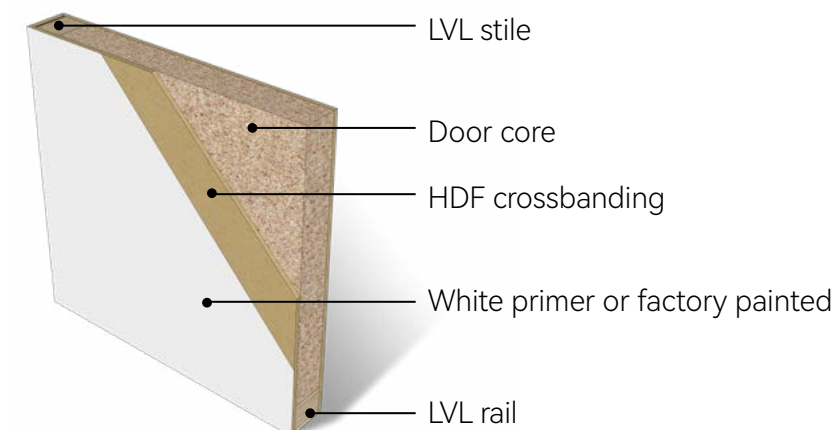

* None rated or 20min rated



STAIN GRADE VENEER FLUSH DOOR

TDM Luxury Doors wood veneer doors provide a stylish wood appearance. Our hardwood edge lipping design provides impressive durability and seamless beauty to a modern veneer flush door.

Wide selection of natural veneers and reconstituted veneer matching options make every door unique and perfect for your project.



- 5-ply construction, bonded core
- Wide variety of domestic and exotic species, cuts, matches and grades to meet any need.
- Veneer edge matching door face as standard, hardwood edge available upon request
- Particleboard core, agrifiber core, mineral core and sound core options available
- WDMA - A grade or AA grade veneer
- Catalyzed polyurethane factory finish to meet WDMA TR-6
- Factory-machined to meet exact requirements for door hardware
- Sound core up to STC 42
- Meets UL 10C positive-pressure fire ratings: 20-, 45-, 60- and 90-minute

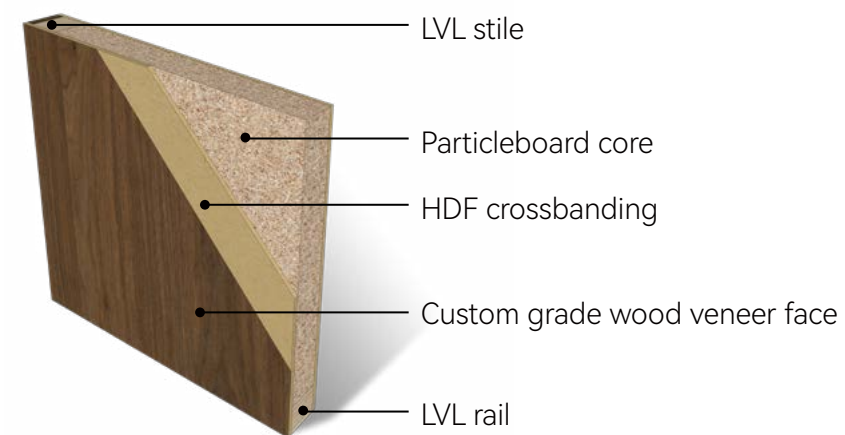

* None rated or 20min rated



HPDL FLUSH DOOR

If you are looking for BEAUTY, DURABILITY, AND VALUE, High-Pressure Decorative Laminate (HPDL) doors are the one. TDM Luxury Doors innovates adjustable jambs and casings with super flexible HPDL wrapping, which is compatible with door design in colors and styles.



- Consistent appearance from opening to opening
- 5-ply construction, bonded core
- PVC edgebanding matching HPDL door face
- Particleboard core, agrifiber core, mineral core and sound core options available
- HPDL from Wilsonart, Formica etc are available
- Jambs and casings wrapping with same color HPDL design is available
- Factory-machined to meet exact requirements for door hardware
- Meets UL 10C positive-pressure fire ratings: 20-, 45-, 60- and 90-minute
- Sound core up to STC 42

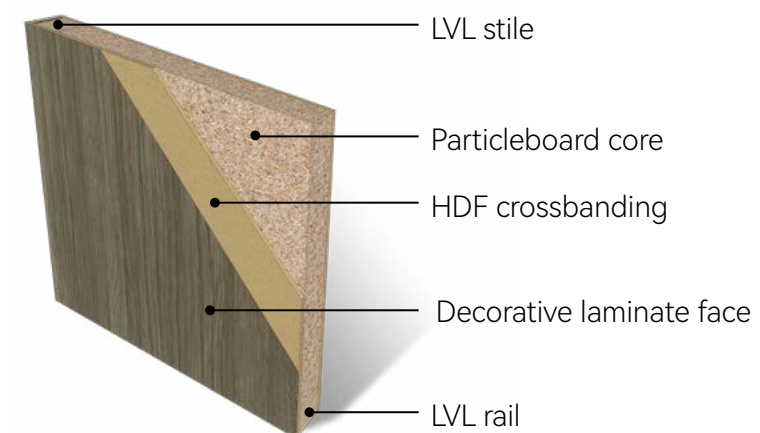

* None rated or 20min rated



CONSTRUCTION

EXCELLENCE IN CONSTRUCTION

TDM Luxury Doors takes craftsmanship and quality as the top priority. We constantly evaluate our process, which incorporates state-of-the-art automated technology with handcrafted techniques to create manufacturing efficiency and consistency. This practice allows us to deliver architectural wood doors of the highest quality standards to your project on time and with your exact specifications.

BONDED CORE

- Stiles and rails bonded to the core for a uniform bond between all components.
- Meets WDMA/AWS custom and premium grade quality standards

CORE MATERIALS

- Particleboard core
- Agrifiber core
- LSB core
- Sound core
- Mineral core

ADDED VALUE

- Factory machining of hardware assures quick, correct installation
- Wood jambs and factory glazing available
- On-time, reliable delivery
- Consistent factory finish.

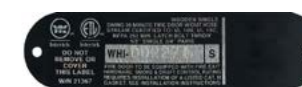
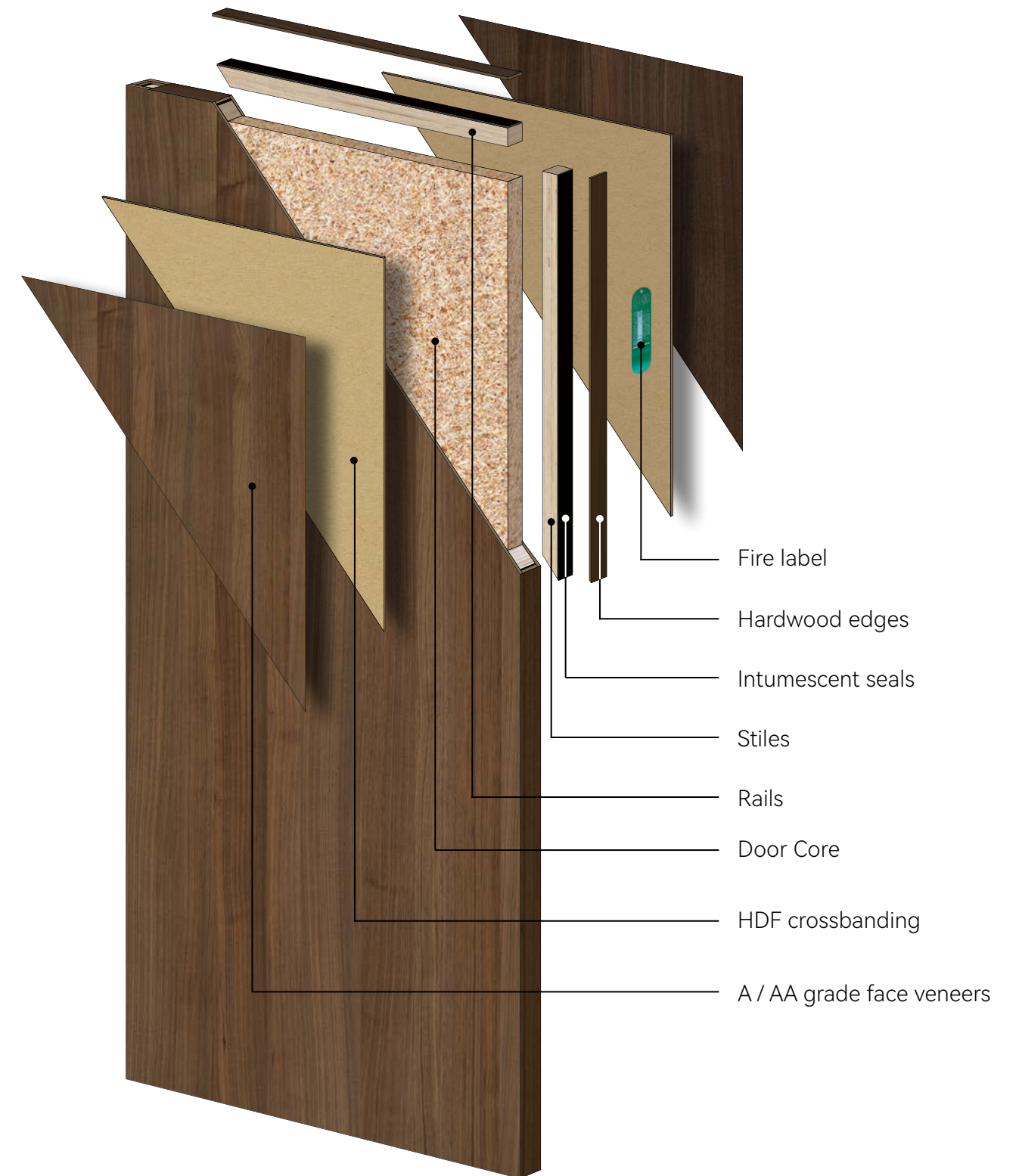

• 20Min fire label







• 60Min fire label



• 45Min fire label



• 90Min fire label

FLUSH DOOR CORE OPTIONS						
	DOOR CONSTRUCTION	Particleboard Core	LSB Core	Multi-layer Composite Core	Composite Sound Core	Mineral Core
	THICKNESS	1-3/4"	1-3/4"	1-3/4"	1-3/4" and 2-1/4"	1-3/4"
	MAX SIZES	Single: 4'x9' Double: 8'x9'	Single: 4'x9' Double: 8'x9'	Single: 4'x8' Double: not allowed	Single: 4'x8' Double: not allowed	Single: 4'x8' Double: 8'x8'
	CORE	Particleboard	LSB	Particleboard with mineral layer enhancement	Composite sound core, multi-ply construction	Incombustible mineral core with mineral layer enhancement
	POSITIVE PRESSURE FIRE RATINGS	ITS-WH 20-Minute Fire Door	ITS-WH 20-Minute Fire Door	ITS-WH 45-, 60-Minute Fire Door	ITS-WH 20-, 45-Minute Fire Door	ITS-WH 45-, 60-, 90-Minute Fire Door
	ACOUSTICAL RATINGS	STC 30-32	STC 30-32	STC 36	STC 42-45	STC 35
	RAILS	1-3/8" LVL, top and bottom	1-3/8" LVL, top and bottom	1-3/8" LVL, top and bottom	1-3/8" LVL, top and bottom	2-1/8" mineral composite, top and bottom rails
	STILES	1-3/8" LVL	1-3/8" LVL	1-3/8" LVL	1-3/8" LVL	2-1/8" mineral composite stiles
	5-PLY WOOD VENEER DOORS					
FACES	WDMA A grade or AA grade veneer, cut & species of choice, or mill option primer or painted surface	WDMA A grade or AA grade veneer, cut & species of choice, or mill option primer or painted surface	WDMA A grade or AA grade veneer, cut & species of choice, or mill option primer or painted surface	WDMA A grade or AA grade veneer, cut & species of choice, or mill option primer or painted surface	WDMA A grade or AA grade veneer, cut & species of choice, or mill option primer or painted surface	
CROSSBANDS	High Density Fiberboard (HDF)	High Density Fiberboard (HDF)	High Density Fiberboard (HDF)	High Density Fiberboard (HDF)	High Density Fiberboard (HDF)	
EDGES	Matching veneer edgebanding or matching hardwood edge	Matching veneer edgebanding or matching hardwood edge	Matching veneer edgebanding or matching hardwood edge	Matching veneer edgebanding or matching hardwood edge	Matching veneer edgebanding or matching hardwood edge	
HPDL DOORS						
FLUSH FACES	0.7-1.2mm HPDL	0.7-1.2mm HPDL	0.7-1.2mm HPDL	0.7-1.2mm HPDL	0.7-1.2mm HPDL	
CROSSBANDS	HDF	HDF	HDF	HDF	HDF	
EDGES	Customized PVC edgebands matching face HPDL	Customized PVC edgebands matching face HPDL	Customized PVC edgebands matching face HPDL	Customized PVC edgebands matching face HPDL	Customized PVC edgebands matching face HPDL	

CUSTOM DOOR OPTIONS

Any custom design you propose, leave it to us. Our craftsmen are experts in handcrafting unique custom doors of the highest quality. From oversized doors to unique veneers to highly detailed inlays, TDM Luxury Doors can provide wooden doors that suit your heart's desire.

OVERSIZED DOOR

Sometimes, great ideas call for bigger doors. We can provide your projects with handcrafted doors that meet your exact needs, from thick doors to wide doors. TDM Luxury Doors can produce high-quality custom doors up to 5 feet wide or 12 feet high with a thickness up to 4 inches. Larger sizes can be made in pieces for field assembly.

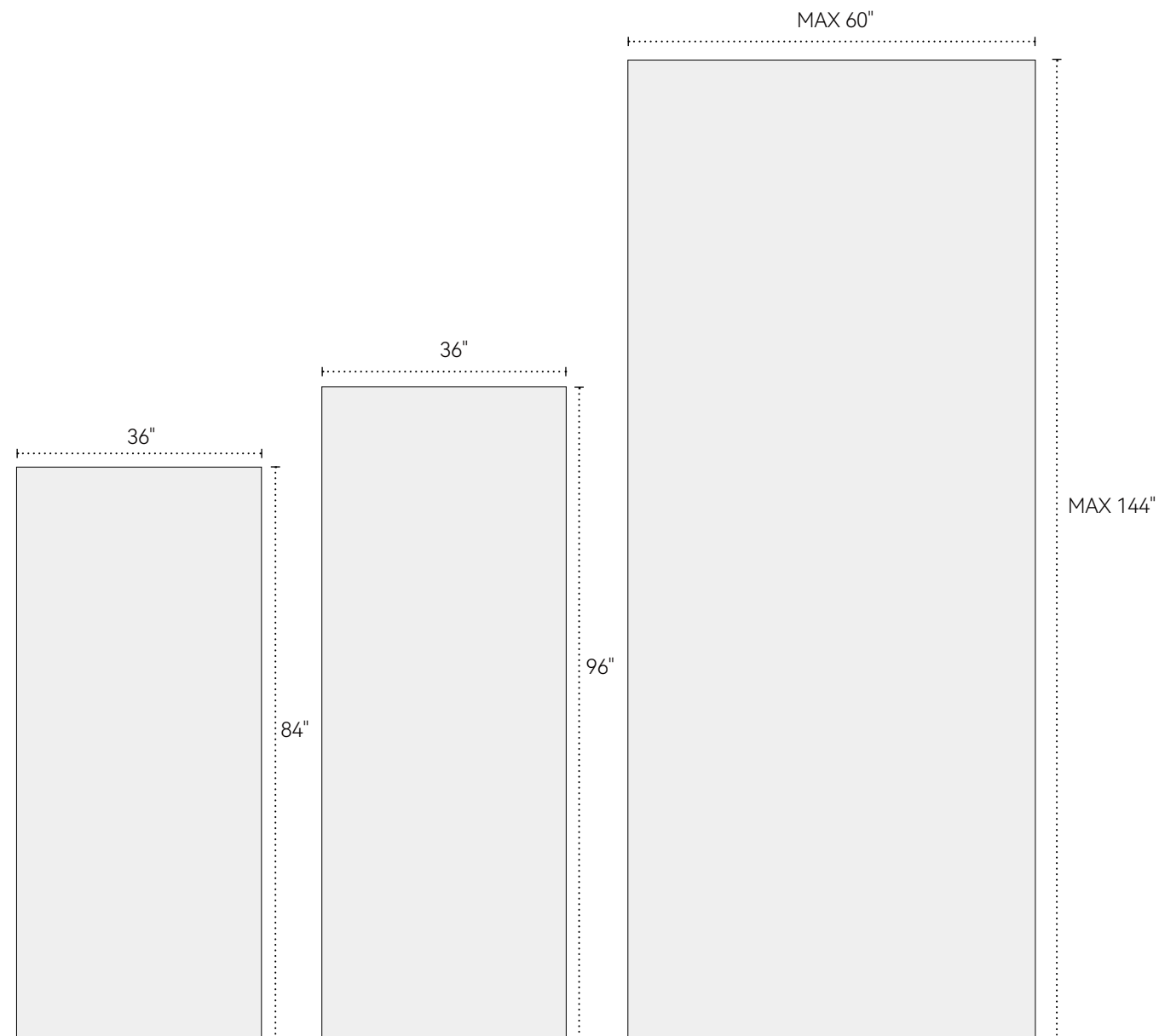

VENEER SKETCH FACES OPTIONS

A sketch face is a single-ply veneer, cut and designed in patterns of varying intricacy to meet specifications of mechanical assembly in the grain or character appearances of veneer used for each segment.

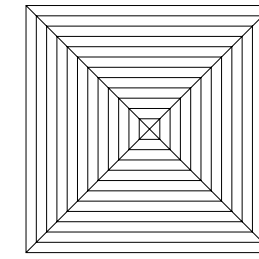

Box

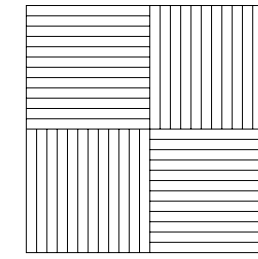

Parquet

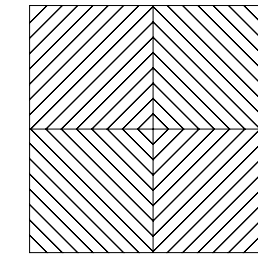

Diamond

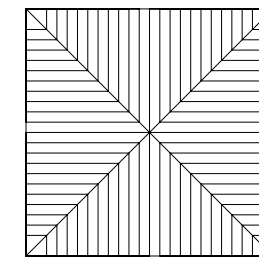

Reverse Box

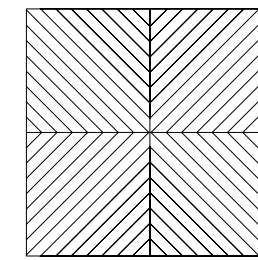

Reverse Diamond

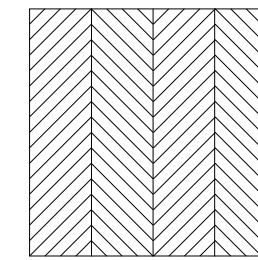

Herringbone



CARVING / INLAY OPTIONS

Customized metal/wood trims inlay, profile carving, sometimes change a boring flush door design to a unique and beautiful one. Work with TDM Luxury Doors to get your unique design.

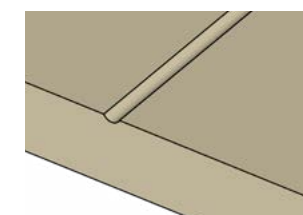

U - groove

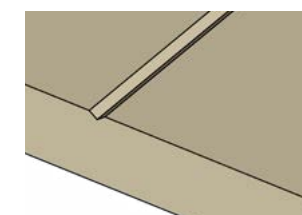

V - groove

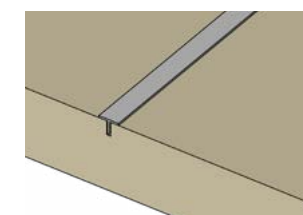

T- metal strip

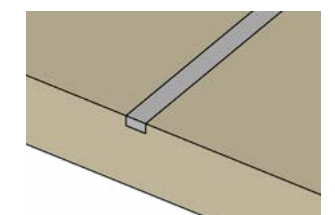

Square metal strip

FLUSH DOOR DESIGN OPTIONS

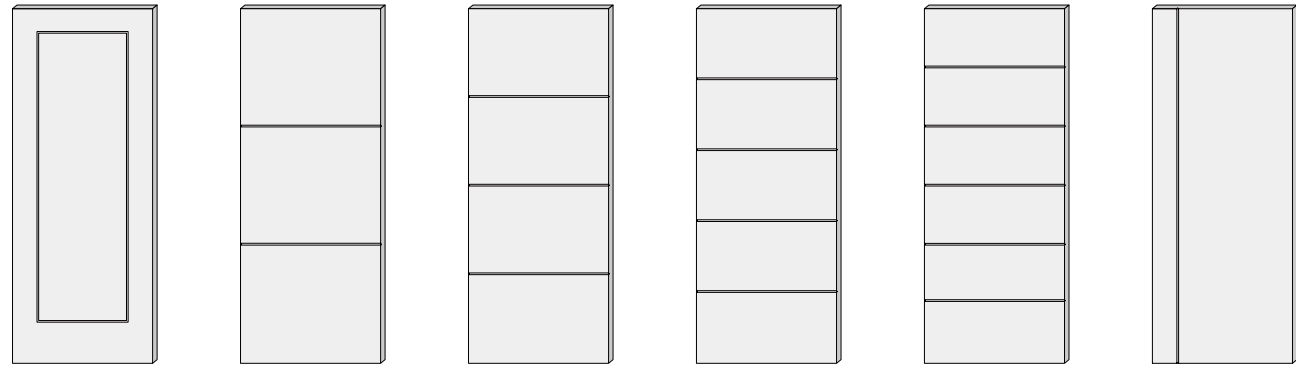

01 02 03 04 05 06

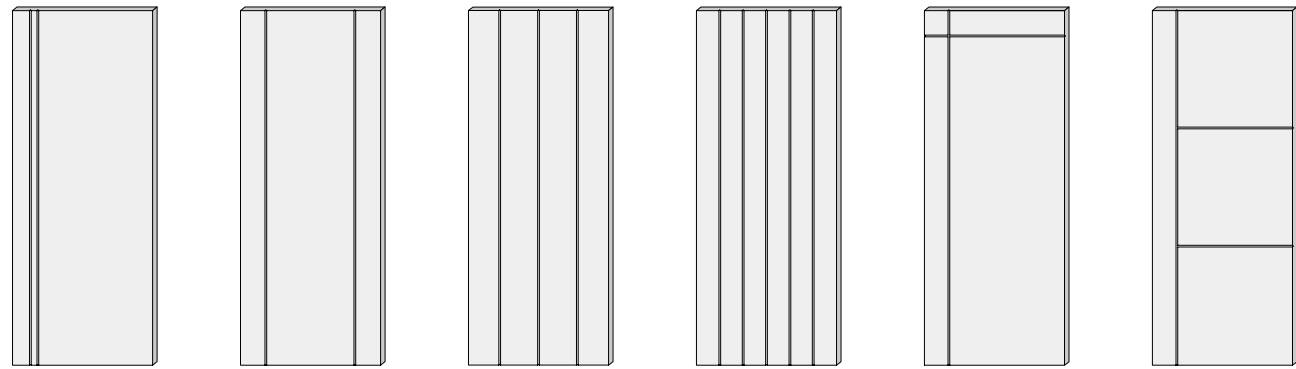

07 08 09 10 11 12

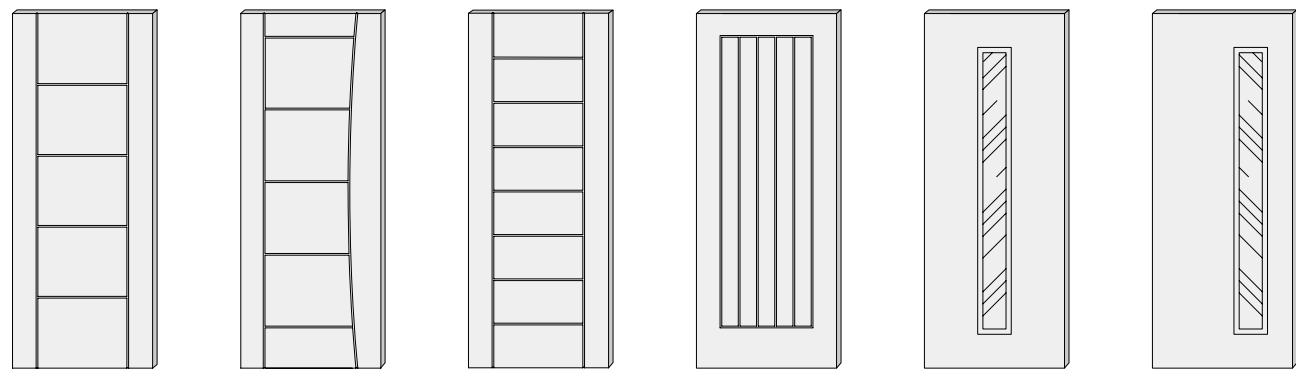

13 14 15 16 17 18

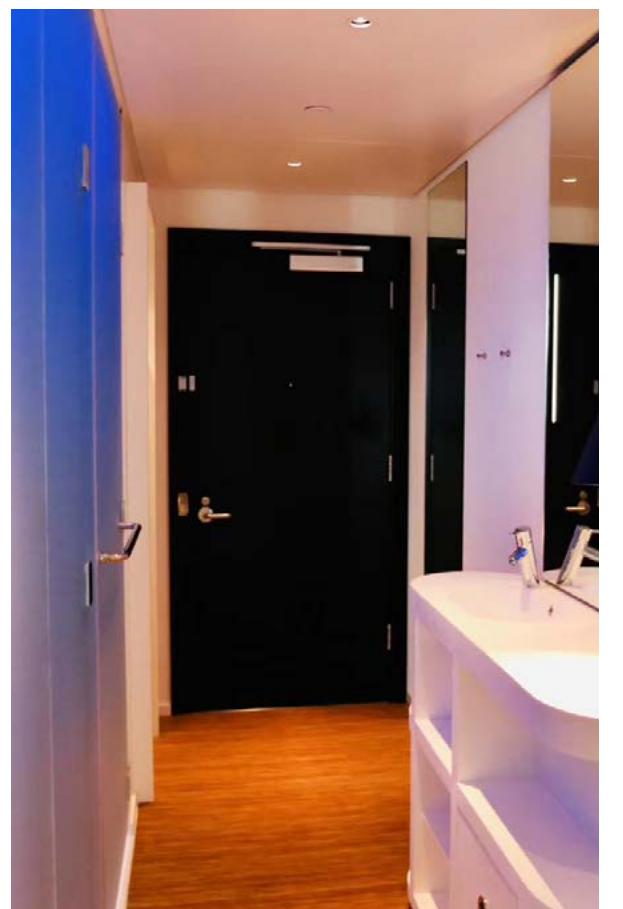
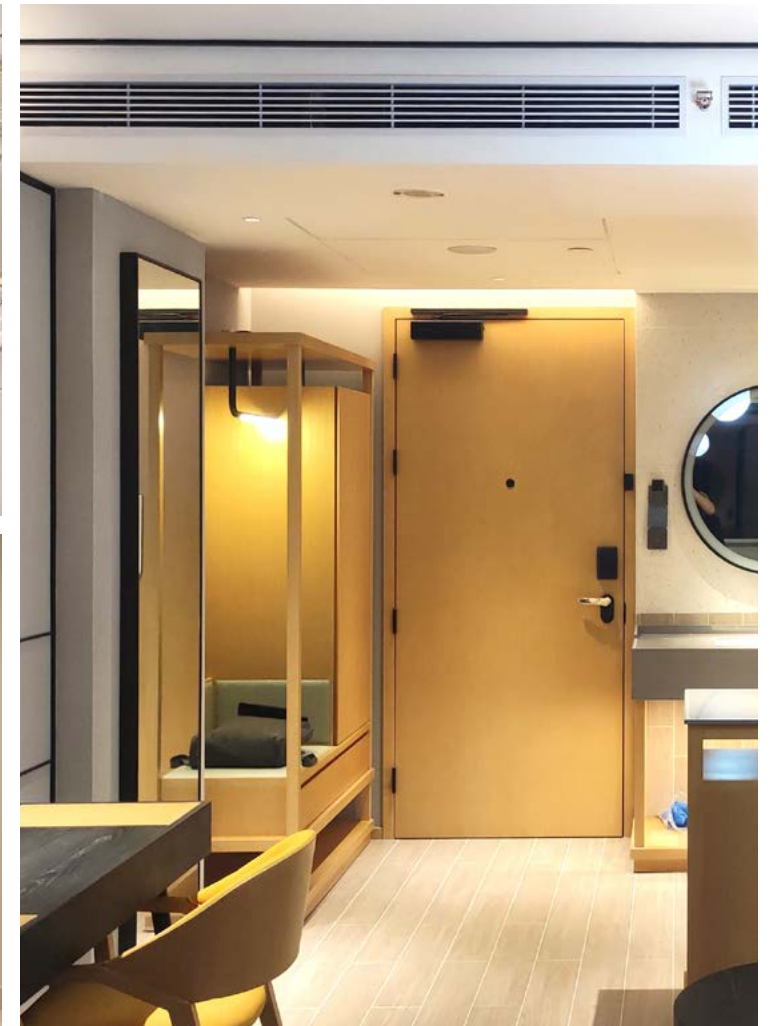

STILE & RAIL WOOD DOOR

Stile and rail construction method not only gives wooden doors crisp, clean lines that are architecturally correct, but also it enables greater versatility to build virtually any door style. The components of stile and rail doors can be combined to create the configuration you desire.

Paint Grade MDF Stile & Rail Door

Stain Grade Veneer Stile & Rail Door

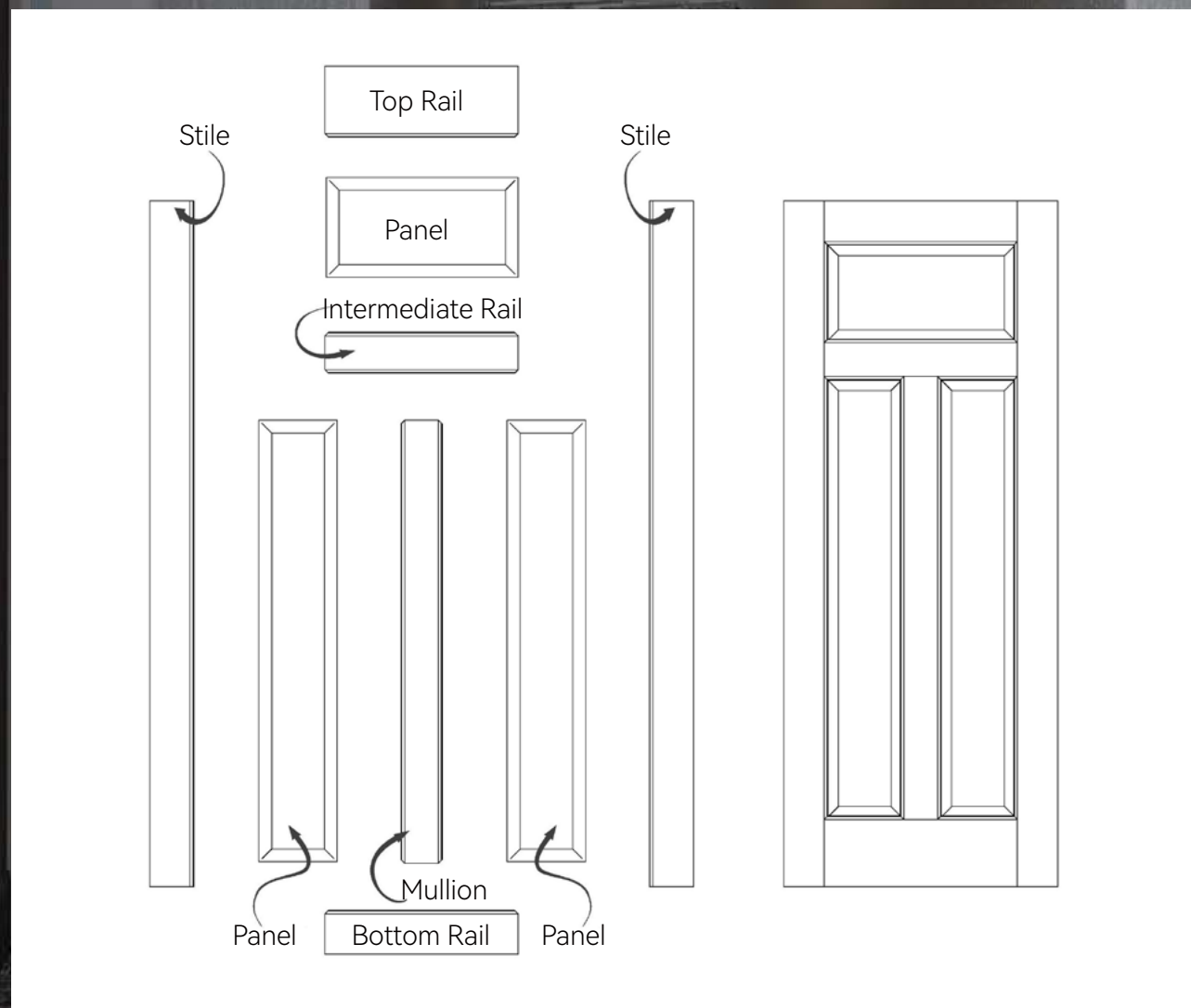

PAINT GRADE STILE & RAIL DOOR

TDM Luxury Doors takes LVL core and laminated with HDF as standard construction for painted door applications. LVL core guarantees high performance for rigid structure and superior screw holding. HDF surface is the best choice for high standard paint finishing.



- Built with LVL core and real stile and rail construction
- High density fiberboard surface, providing unrivaled smoothness and finishing
- Different glass insert available to offer a true divided lite option
- Primer or catalyzed polyurethane finish to meet WDMA OP-6
- Factory-machined to meet exact requirements for door
- Meets UL 10C positive-pressure fire ratings: 20-, 45-minute
- Sound core up to STC42

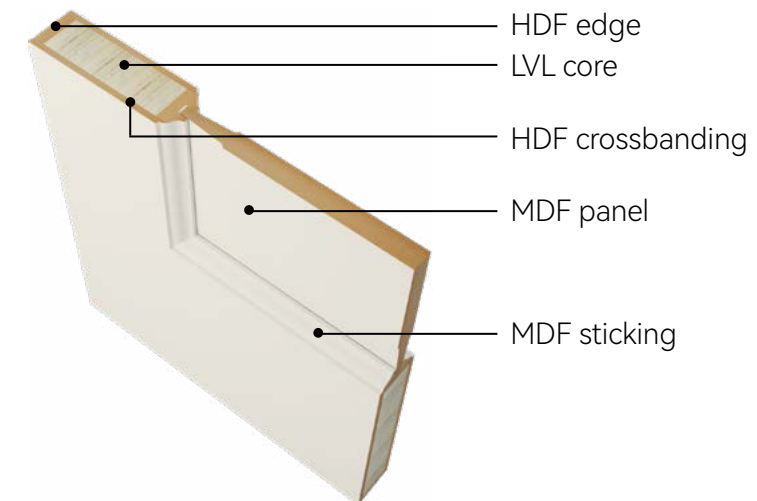

* None rated



STAIN GRADE VENEER STILE & RAIL DOOR

Whether you're restoring a historic building or wanting to add the perfect detail to a new design, you'll find the elegance and beauty you seek in our Stile & Rail Doors. We offer the highest quality product, aesthetic compatibility, and design integrity.



- Customized panel and sticking profile available
- LVL core as standard with HDF crossbanding
- Wide selection of natural or reconstituted veneer
- Different glass or resin panels insert available to offer a true divided lite option
- Matching hardwood or veneer edgebanding
- Catalyzed polyurethane factory finish to meet WDMA TR-6
- Factory-machined to meet exact requirements for door hardware
- Meets UL 10C positive-pressure fire ratings: 20-, 45-minute
- Sound core up to STC 42

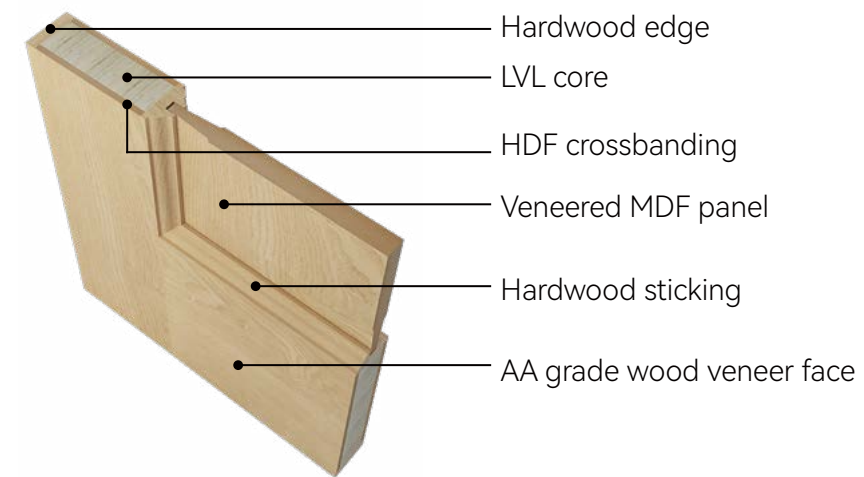

* None rated



CUSTOMIZED DESIGN OPTIONS

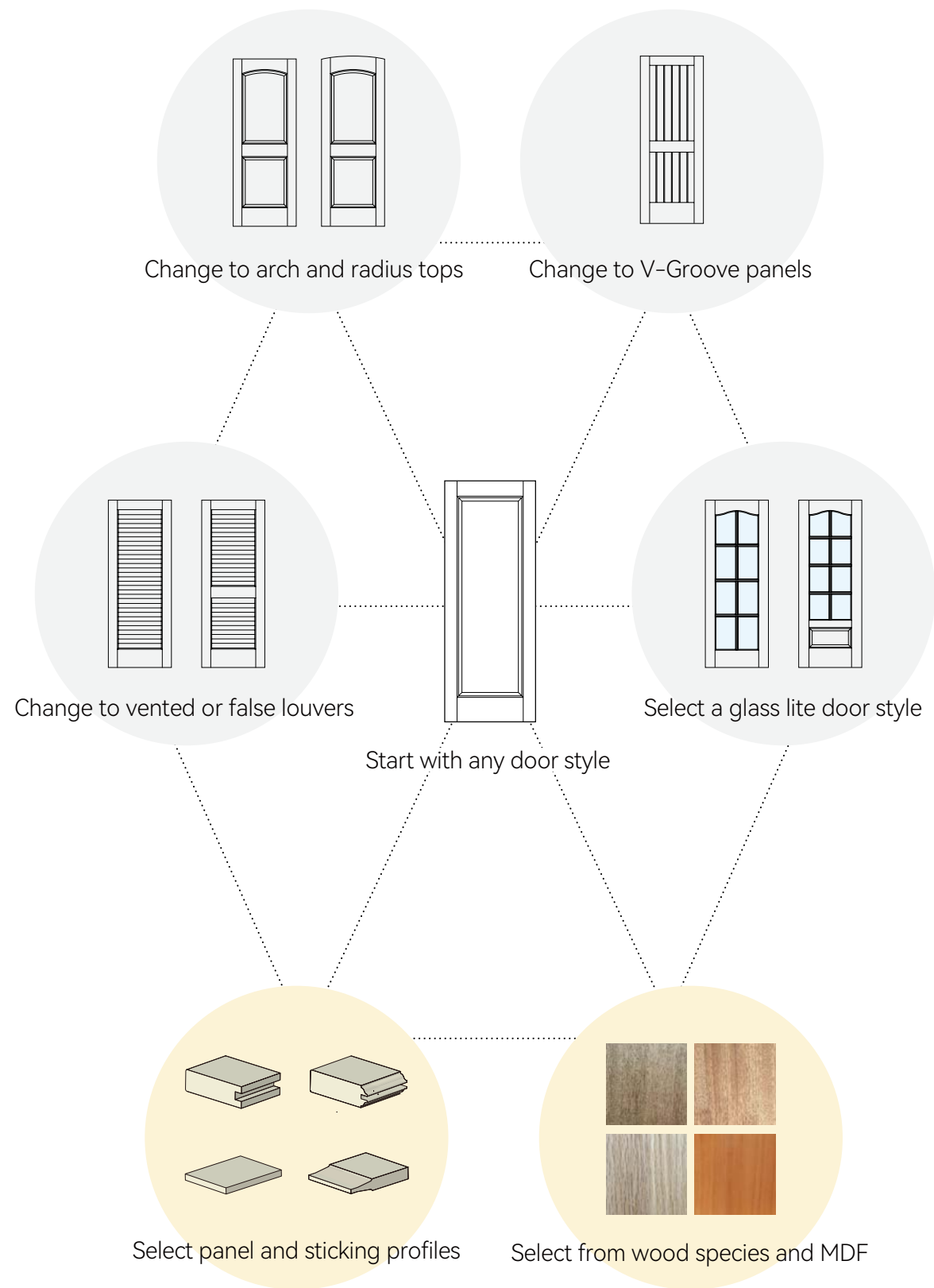

PROFILE DESIGN OPTIONS

STICKING PROFILE OPTIONS

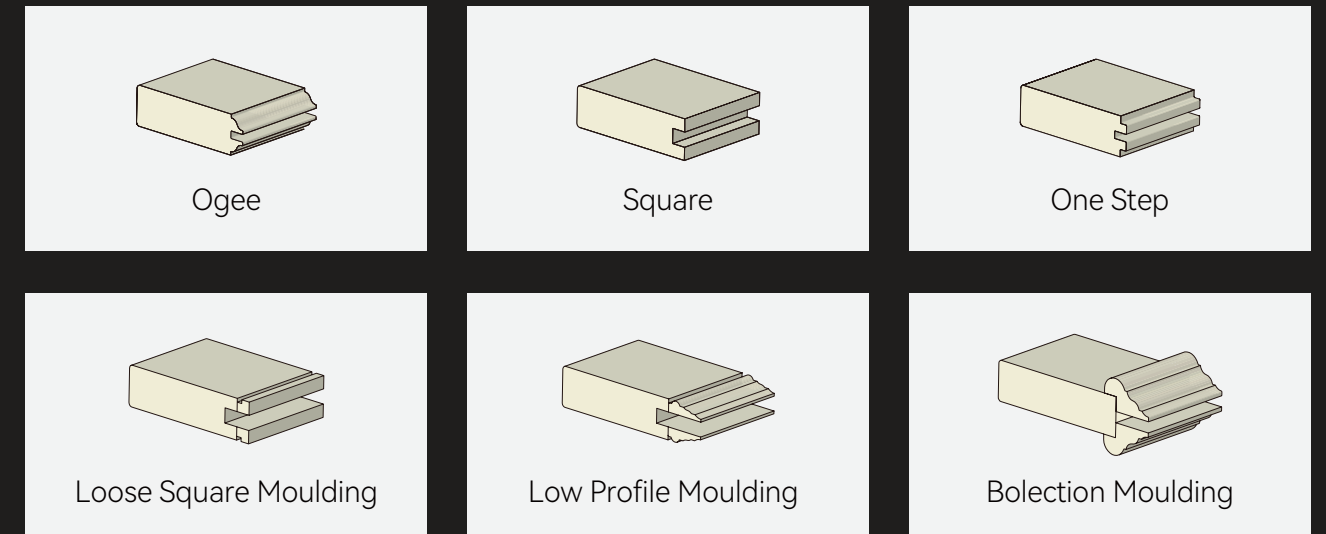

PANEL PROFILE OPTIONS

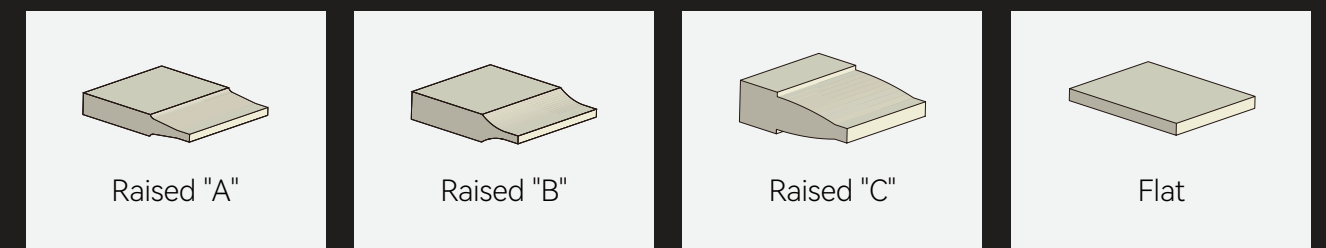

GLASS DOOR PROFILE OPTIONS

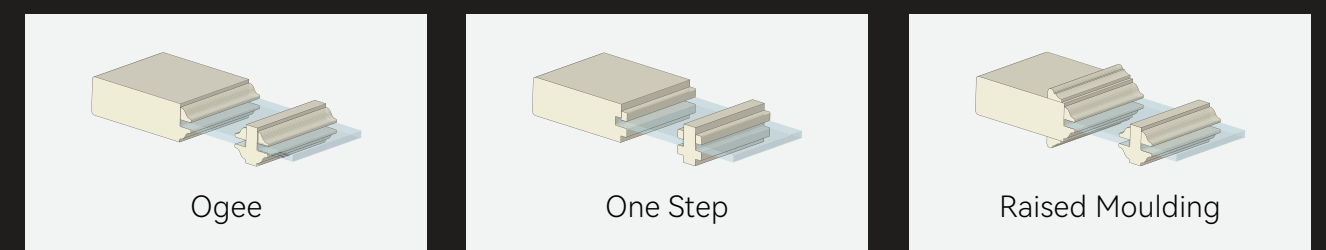

PANEL DOOR DESIGN OPTIONS

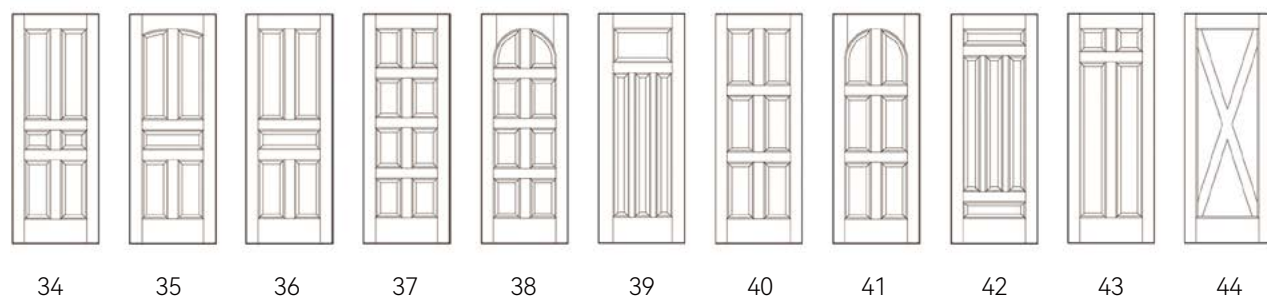
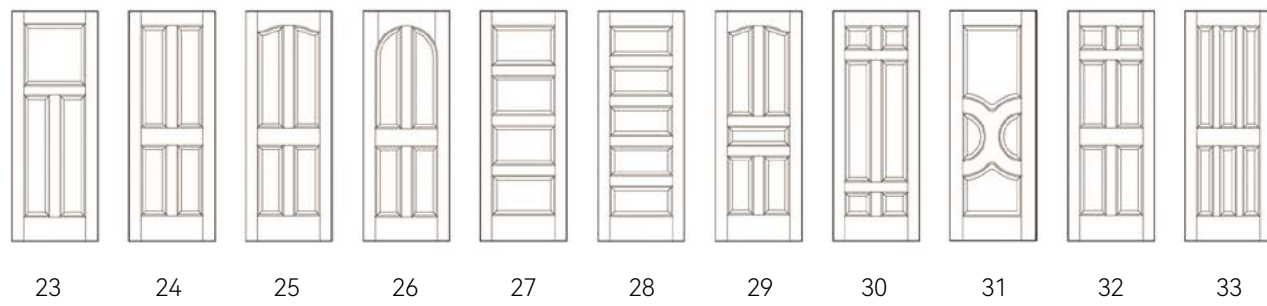
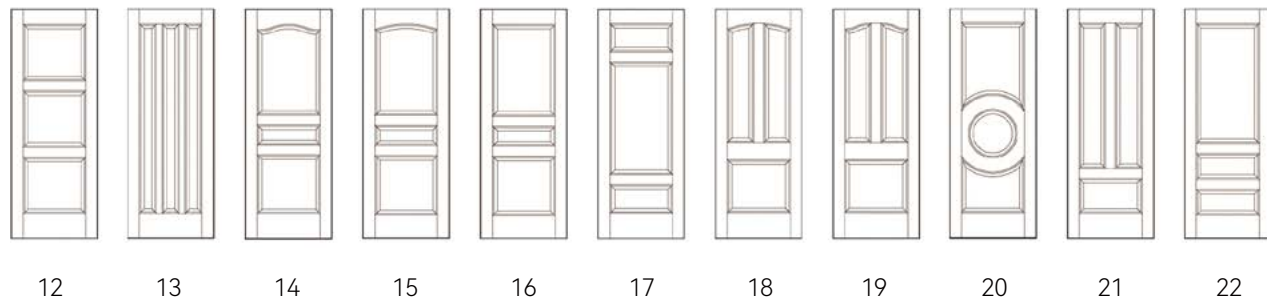
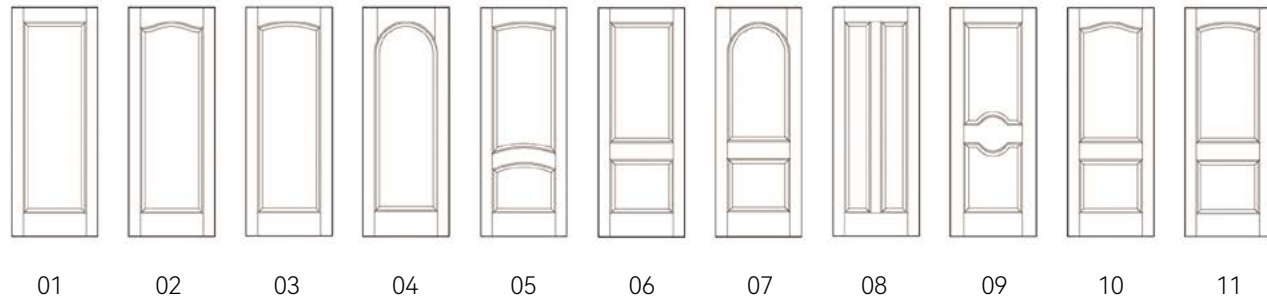

GLASS DOOR DESIGN OPTIONS

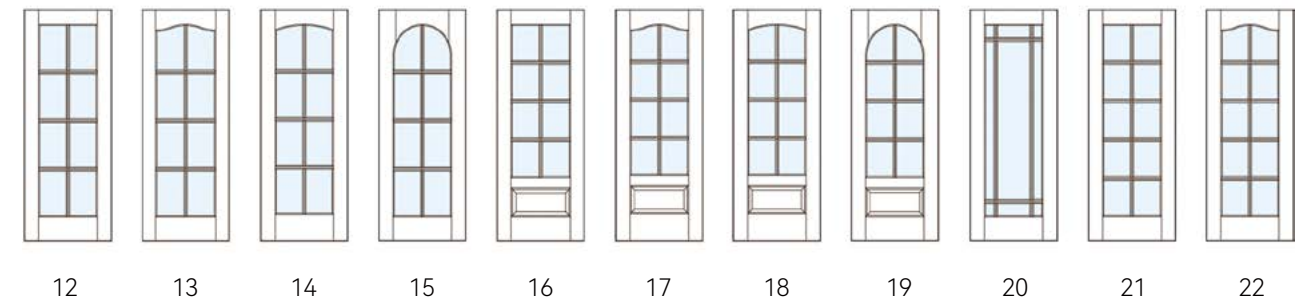
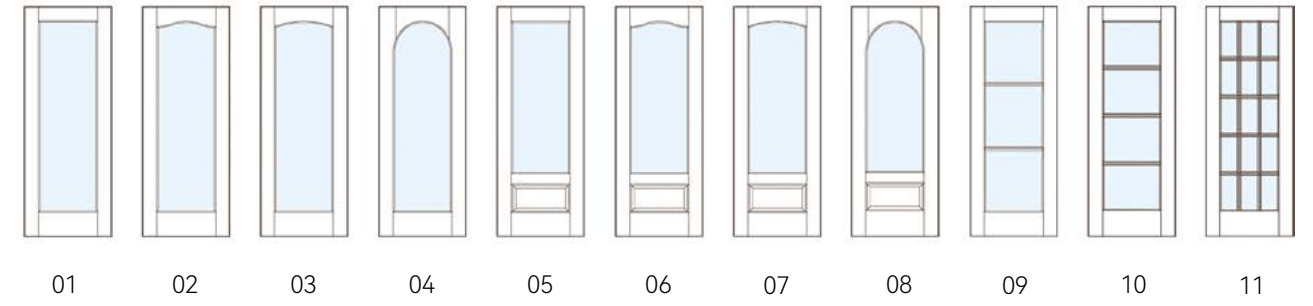

LOUVER DOOR DESIGN OPTIONS

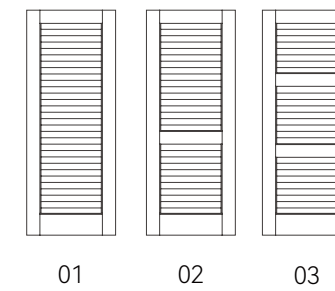

*TDM Luxury Doors offers customized style design options, and don't hesitate to contact our sales representatives for more information.

STAIN COLOR OPTIONS



Ice oak



Light ice oak



Clay gray oak



Teak oak



Black oak



Dark wenge oak



Light clay gray oak



Natural oak



Walnut oak



Natural Black Walnut

*TDM Luxury Doors offers customized paint or stained color options, and don't hesitate to contact our sales representatives for more information.

ADDITIONAL PRODUCT INFORMATION

DOOR MACHINING OPTIONS

TDM Luxury Doors will machine your door for any architectural builder's hardware requirement. We use advanced machinery and programming to deliver doors that are ready to accept the hardware your application requires. Contact your TDM Luxury Doors representative to obtain more detailed information about our machining capabilities.

PREHUNG

Like our doors, TDM Luxury Doors prehung units are built using premium construction techniques, high-quality craftsmanship, and complete flexibility. We build our prehung units to order and can supply jambs in any width for any size door. Our automated, precise machinery ensures every prehung unit is high quality and machined precisely to your specifications.



FIELD FINISHING REQUIREMENTS

All of TDM Luxury Doors doors require some field preparation before finishing. MDF doors are factory shipped with a primer that is not a sealant. This primer must be scuff-sanded, and nail holes should be filled before painting. Unfinished wood doors must be prepped and sealed in the field by a professional finisher. All six door sides must be sealed, including the top and bottom.

DOOR STORAGE

All TDM Luxury Doors doors must be stored on a flat surface in a dry, ventilated area before installation. Doors should not be leaned against walls, and center supports must be used when they are stored horizontally on pallets.

WARRANTY

All TDM Luxury Doors wood doors are manufactured to the highest quality and craftsmanship standard and are backed by limited three-year warranties against workmanship and materials defects.

PREMIUM KNOCK-DOWN JAMBS

For non-rated openings requiring wood jambs, TDM Luxury Doors offers a turnkey knock-down jamb in paint-grade plywood or any stain-grade wood species. Our KD jambs come pre-machined to match each door in your order and are packaged and labeled to make job site organization and installation quick and easy.

TYPICAL WOOD FRAME DESIGN



Drywall double rabbet jamb with 2 sides adjustable casings



Drywall single rabbet jamb with 1 side adjustable casing



Drywall outside flush jamb with in-swing door



Hidden door with wall panel



Concrete wall with shadow gap feature + Single rabbet jamb with 1 side adjustable casing



Drywall wall with shadow gap feature + Single rabbet jamb with 1 side adjustable casing



Drywall with shadow gap feature + Double rabbet jamb

TYPICAL METAL FRAME DESIGN

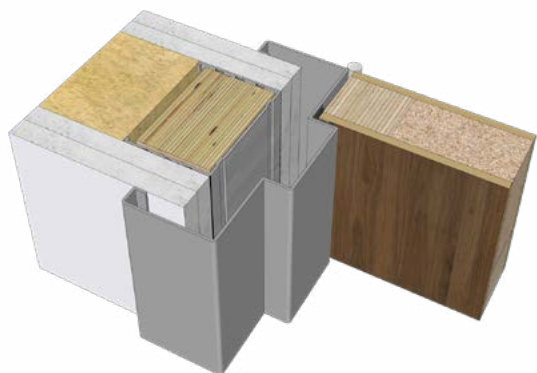

Drywall
Hollow metal frame KD or welded

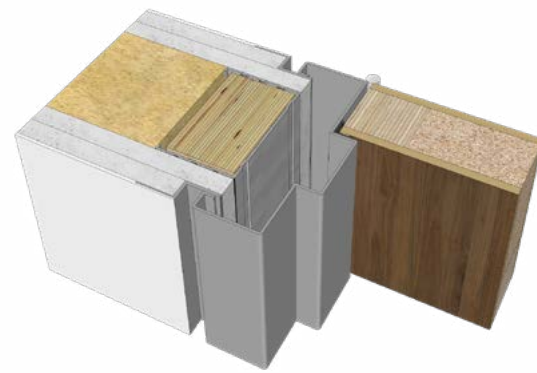

Drywall with shadow gap feature +
Hollow metal frame KD or welded

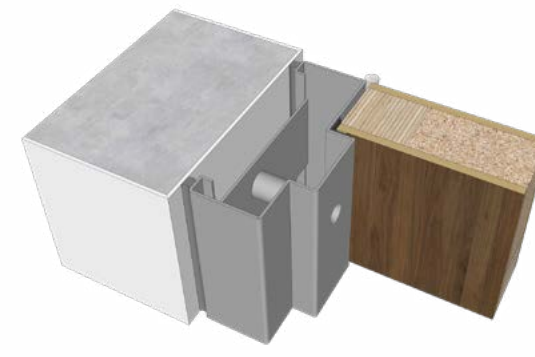

CMU wall
Hollow metal frame with dimpled anchor

COOPERATED HARDWARE SUPPLIER

ASSA ABLOY

dormakaba

OTLAV

OLIVARI

SIMONSWERK

ECO

HÄFELE

SUGATSUNE

